



Cvi

Global Challenges, Innovative Solutions.

model

FCS 3001 KITS & SPARES

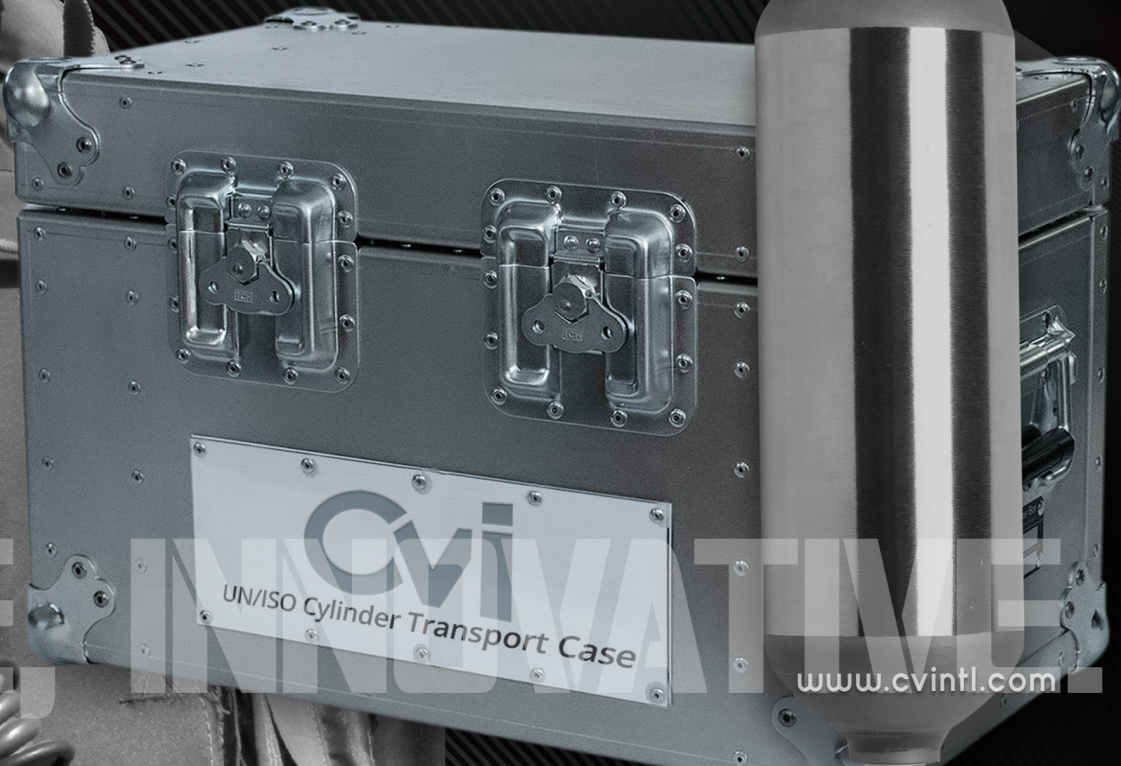

AGILE INNOVATIVE

www.cvintl.com

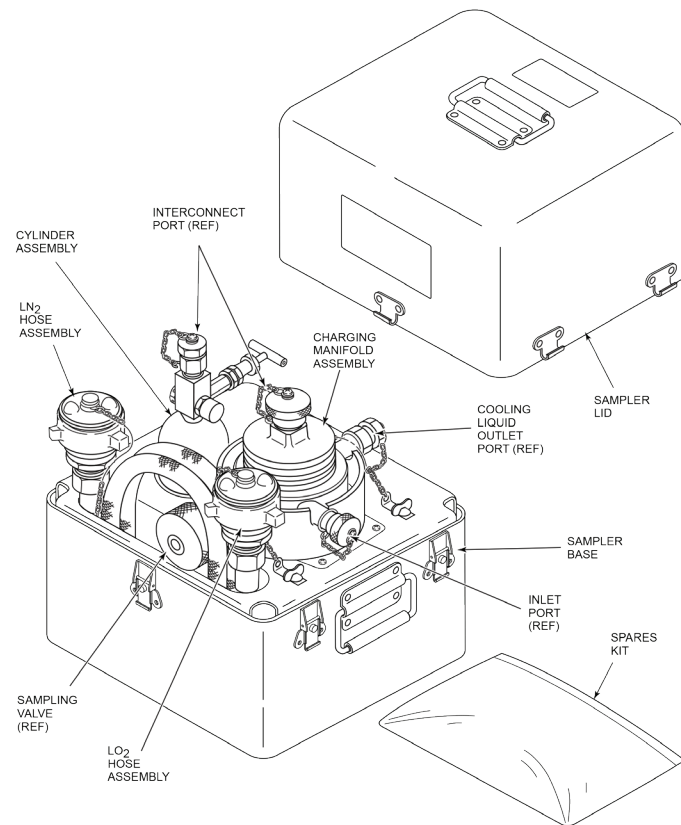

FCS 3001 Specifications

Part Number: 600646

NSN: 6695-01-600-4986

FCS-3001 [Entire Sampler 600646]

It is recommended that the FCS-3001 Sampler be inspected and serviced every ?? hours or every ?? months.

The following pages have suggest servicing kits and spares for various assemblies.

Sample Cylinder Assembly [Spare Kit 6006-CYL]

It is recommended that the Sample Cylinder Assembly be inspected and serviced every ?? hours or every ?? months.

Spares Kit 6006-CYL consists of (600305A Pin, Charging Valve Stem, 600644A Rupture Plug, 600670A Shield Cup Seal). **Entire Assembly Kit: 6006-ASSY.**

Finned Double-Cup Sampler [Spare Kit 6006-FIN]

It is recommended that the Finned Double-Cup Sampler be inspected and serviced every ?? hours or every ?? months.

Spares Kit 6006-FIN consists of (600668C Seal, 600669A Sample Cup Seal, 600273 Pad Upper). **Entire Finned Assembly Kit: 6006-CUP.**

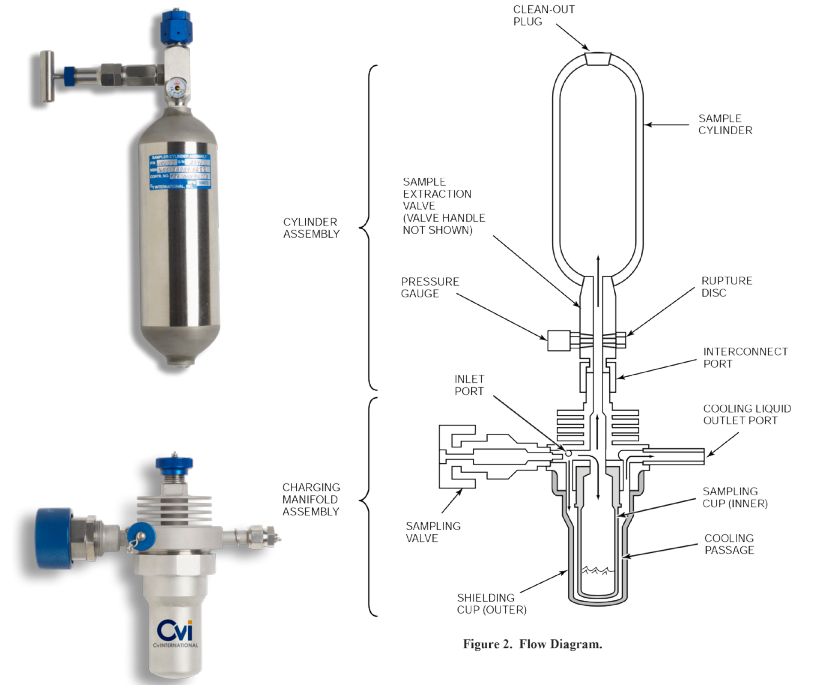

Figure 2. Flow Diagram.



Storage and Handling Case [Entire Case Kit 600542]

A unique aluminum case designed to hold and position the Sampler and Cylinder while sampling and vaporizing as well as securing the sampler for storing and transporting. Included in the case is a replaceable insulation liner which aids in rapid Sampler cool down. Keeping your Cryogenic Sampler Storage and Handling Case well maintained is imperative to the safe and proper use of the sampler.

Part Number	Description	MOQ
600265C	BASE & COVER	1
600287	MUFF ASSY	1
600219	GROMMET SLEEVE	1
600218	NAMEPLATE	1
600210E	SAMPLE CYLINDER ASSY UN/ISO	1
600655	PLUG	1
600211	CYLINDER CRYO UN ISO 9809-4	1
600710C	CYLINDER MANIFOLD ASSY	1
600644A	RUPTURE PLUG	1
600726A	PRESSURE GAGE 0-3000PSI	1
600712B	VALVE ASSY CYLINDER	1
600713A	VALVE BONNET ASSY	1
600311B	LOCKNUT	1
600302C	BONNET	1
600530	O-RING	1
600531	WELDED STEM ASSY	1
600529A	LOCKNUT	1
600528A	STEM	1
600527B	BONNET	1
600535	O-RING	1
600536A	CAP	1
600312B	SCR SET CUP POINT 3/8-24 X 3/4	1
600310C	HANDLE	1
600715C	KEL-F-SEAT	1
600253B	NUT, INTERCONNECT PORT	1
600525A	ADAPTER	1
600308A	BODY	1
600254	CAP ASSY	1
600733	NAMEPLATE	1
600264C	CHARGING MANIFOLD ASSY	1
600666B	MANIFOLD WELD ASSY	1
600660A	SHIELD CUP ASSY	1
600663A	SAMPLE CUP ASSY	1
600230A	SAMPLING VALVE ASSY	1
600231B	STEM ASSY	1
600360	CHARGING VALVE TIP	1

Part Number	Description	MOQ
600361	CHARGING VALVE PIN	1
600305A	PIN, CHARGING VALVE STEM	
600242A	CAP ASSY	1
600243A	CAP ASSY - INLET	1
600244A	CAP ASSY - OVERFLOW	1
600673	HANDLE COVER	1
600644A	RUPTURE PLUG	1
600241A	HANDLE	1
600672	HANDLE NUT	1
600233A	JAM NUT - CHARGING MANIFOLD	1
600734	NAMEPLATE	1
600668C	SEAL (AR10304-113AH)	1
600669A	SAMPLE CUP SEAL	1
600670A	SHIELD CUP SEAL	1
600273	PAD UPPER	1
600271	PAD LOWER	1
600220A	CRYO T.O. DECAL	1
600720	CHAIN ASSY-LONG MANIFOLD	1
600675A	SCREW	2
600221C	CHAIN ASSY - SHORT	1
600678A	RECEPTACLE	2
600641	SCREW	6
600906B	SPARES KIT	1
600701	HOSE ASSY-LN2 (BLUE)	1
600700	HOSE ASSY-LOX (GREEN)	1
600543	- UN/ISO SAMPLE CYL ASSY W/ CASE	1
600542	- CYLINDER TRANSPORT CASE	1
600697	KEL-F REPLACEMENT KIT	1
600699	CLEANING & TEARDOWN SEAL KIT	1

FCS SPARES